



Huntington Beach City School District



Conceptual District Vision - Dwyer Middle School Site Presentation

- 1. Background of Completed Facilities Needs Assessments**
- 2. Overview of District Wide Recommended Priorities**
- 3. Preliminary Goals and Objectives**
- 4. Existing Campus Conditions**
- 5. Model Classroom and School, 21st Century Learning Overview**
- 6. Q&A**

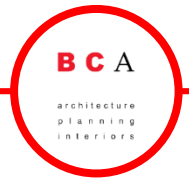

- 1. Site Visits Were Conducted on 8/3/16 to Understand the District's Campuses**
- 2. BCA Analyzed Findings From the Site Visits**
- 3. Preliminary Priorities For Each Campus Were Established with the Superintendent and Multiple Members of the M&O Staff.**
- 4. Completed Facilities Needs Assessment Reports that Summarized BCA Findings and Recommendations**

Priority 1: 21st Century Classrooms and upgrades to portables, AB300 [DSA will require it to be in this phase], ADA, electrical gear/service upgrades, abatement, restroom and ADA upgrades, roof replacement, plaster repair at Dwyer.

Priority 2: Multipurpose and STEAM Labs at the [2] Middle Schools, LED lighting and lighting controls, air conditioning and controls, new playground at Smith, Admin. rework, replace concealed spline ceilings at Sowers, upgrade Auditorium at Dwyer.

Priority 3: Learning Commons.

Priority 4: Safety and security single point of entry/exit at Admin., site fencing, remove/modify walkway canopies, restrict roof access, and portables to permanent.

1. Modernize Classrooms and Create 21st Century Standard for Huntington Beach City SD.
2. Code, Health, Infrastructure, Safety and Security.
3. Creating 21st Century Learning Environments.
 - Outdoor Learning, Maker's Labs, STEAM Labs, Learning commons
4. Repurpose Buildings/Rooms where necessary

Existing Campus Conditions DWYER MIDDLE SCHOOL

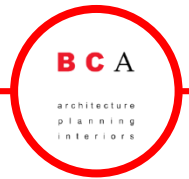

Campus Analysis

Site	10.09 acres
Year Built	1936
Last Modified	2005
Grade Levels	6 – 8
Permanent Classrooms	43
Portable Classrooms	0

Campus Capacity

Current Enrollment	1,296
Permanent Classroom Capacity	1,204 [28 students / classroom]
Permanent Classrooms Needed	4

Summary of Findings

- Auditorium requires renovation, new electrical switch gear, infrastructure and panels, and new lighting.
- Upgrade second floor Staff restroom ADA.
- District adding fan to main building.
- Upgrade parking and drop off.
- Repair/replace exterior plaster.
- New Multipurpose with STEAM Labs to share with Smith Elementary.
- Electrical panel replacement.
- Rework roof access, remove exterior metal stair.
- Eliminate covered walkways.
- Upgrade lighting, not Title 24 compliant, LED fixtures.
- Site access control, fencing, path of travel to Admin.
- Need clocks, phones, and bells.
- ADA compliant handrails at stairs and ramps.
- Roof areas need replacement.



“Good”

- 1 Interactive Display
- Rectangular Desks
- White Board Wall



“Better”

- 2 Interactive Displays (1 Display and 1 Interactive White Board)
- Triangular Desks
- Soft Seating

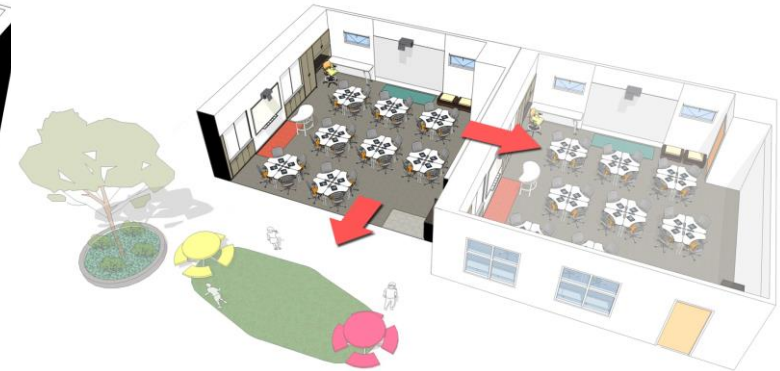

“Best”

- 2 Interactive Displays (1 Display and 1 Interactive White Board)
- Triangular Desks & Soft Seating
- Nanowalls between Classrooms
- Sliding Doors that open up to Outdoor Learning

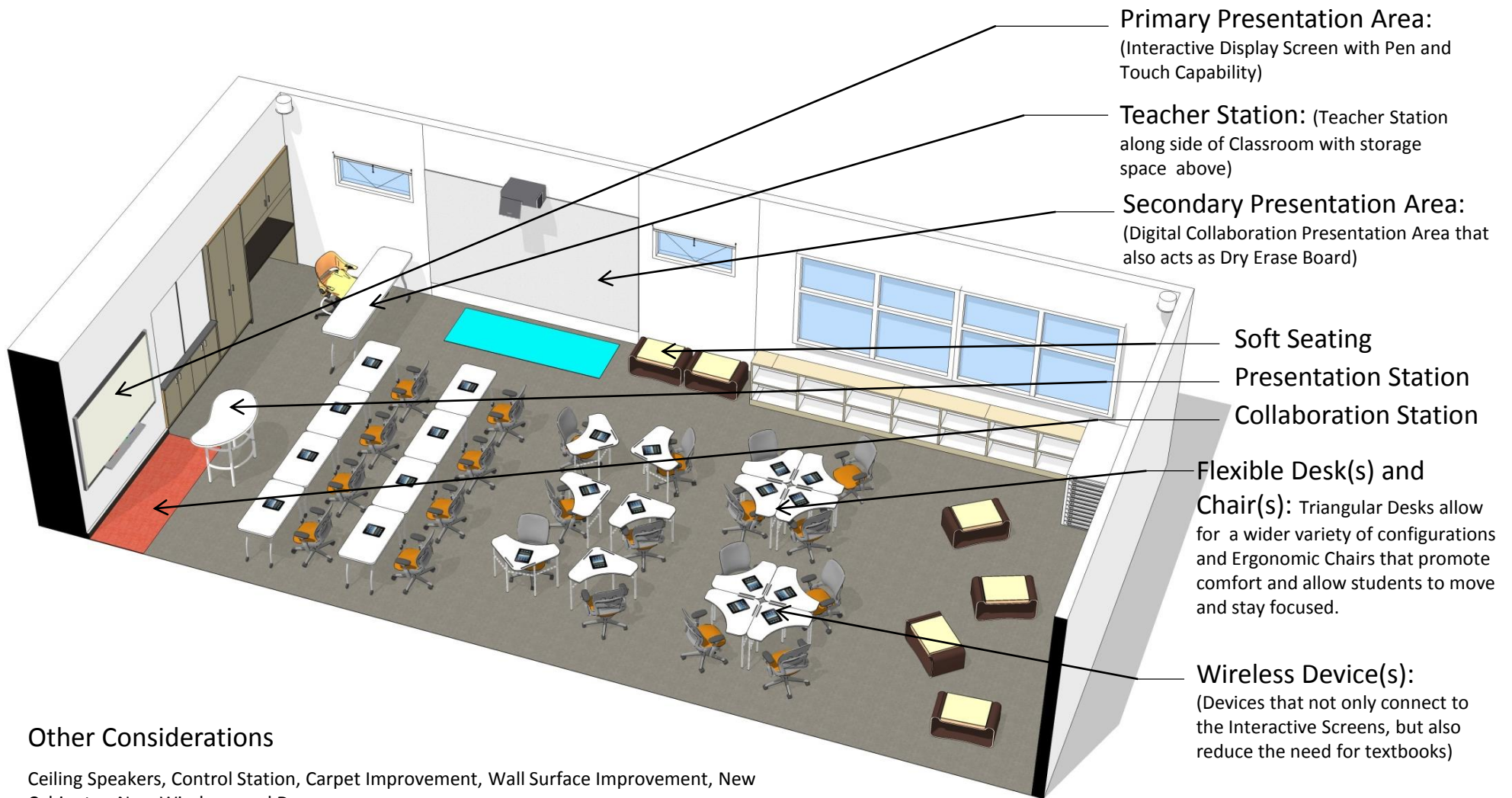

Other Considerations

Ceiling Speakers, Control Station, Carpet Improvement, Wall Surface Improvement, New Cabinetry, New Windows and Doors.

BCA Model School LEARNING COMMONS

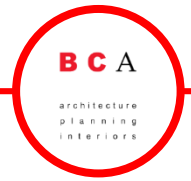

BCA Model School OUTDOOR LEARNING





The Makers Learning Labs allow students to collaborate and work together on various projects. The Makers Labs fit into 21st Century Learning due to the flexibility in its structure and the ways in which it allows students to learn from one another.



BCA Model School BUENA PARK DEMONSTRATION CLASSROOM

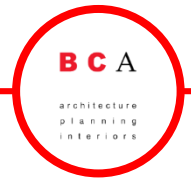

BCA Model School DARTMOUTH STEM LAB



* Middle Schools only

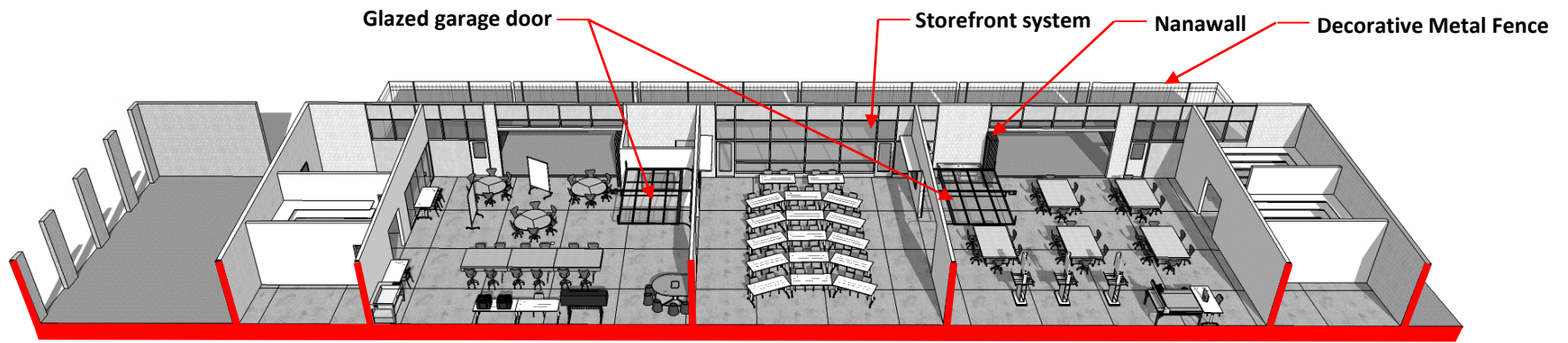

- Existing Lockers
- Storage
- Digital Playground
- Group Presentation & Lecture
- Fab Lab
- Storage

BCA Model School MULTIPURPOSE

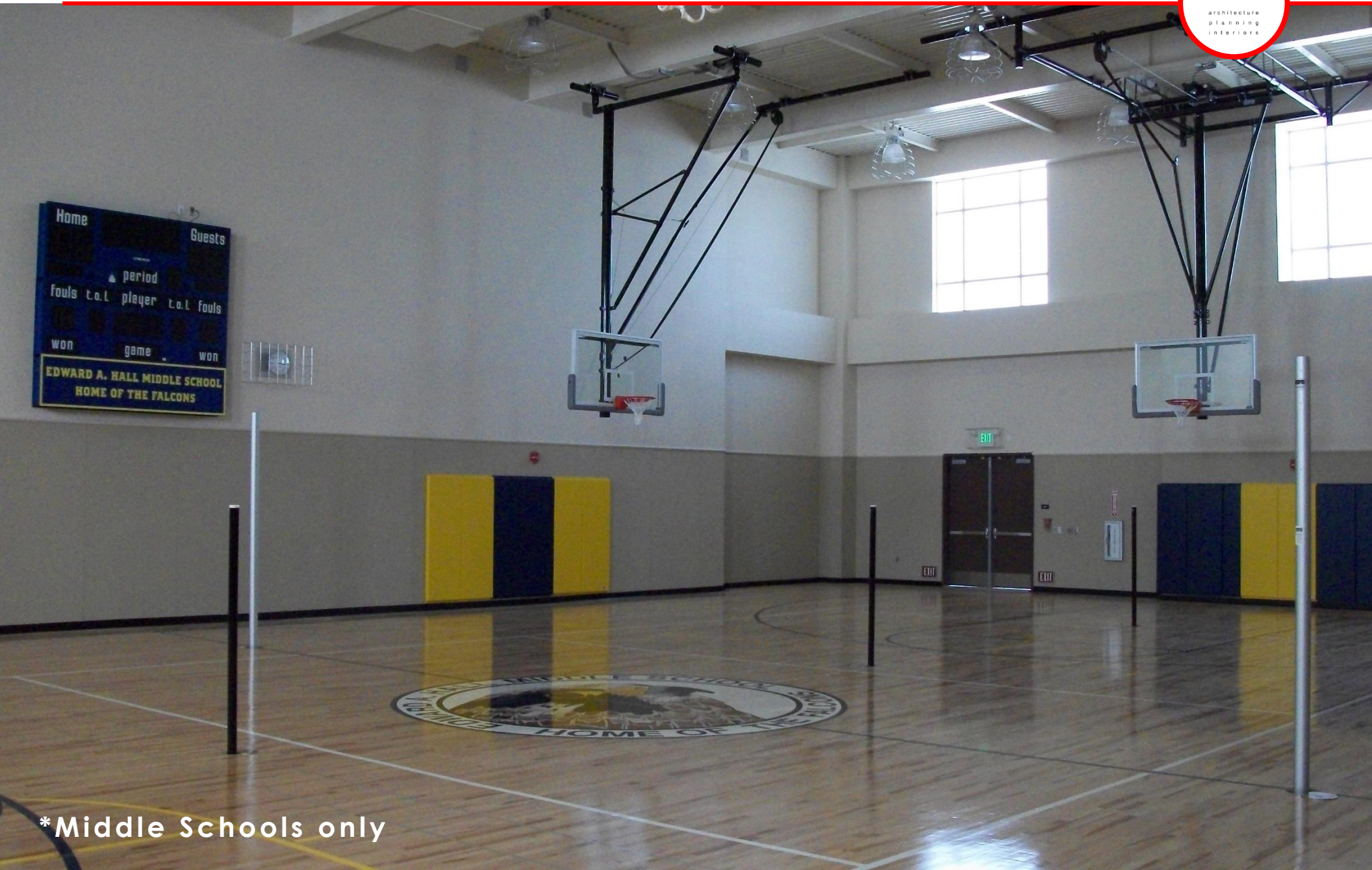

*Middle Schools only

Q & A

