



# Huntington Beach City School District



- 1. Where are we in the process?**
- 2. Measure Q Bond Program Updates**
- 3. District Wide Priorities**
- 4. Measure Q Phasing by Priority**
- 5. Campus Projects & Phasing**
- 6. Schedule**
- 7. Phase 1 Schematic Design**

# Where are we in the process?

---

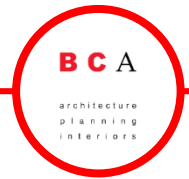

- 1. Project Prioritization Site Meetings** January 10-11, 2017
  - BCA's team held site meetings to review the Bond Program planned projects for each campus.
- 2. Project Prioritization Board Presentation** January 17, 2017
  - BCA's team presented the overall project prioritization for the Measure Q Bond Program.
- 3. Demonstration Classroom Teacher Meeting** March 28, 2017
  - OnPoint presented the designs for each of the (12) demonstration classrooms.
- 4. Phase 1 Schematic Design (SD) Phase** April 17, 2017
  - BCA began the SD phase for the phase 1 projects.
- 5. Schematic Design (SD) Site Committee Meetings** May 3 - 5, 2017
  - BCA's team will meet with each campus site committee to review the SD phase scope/designs for phase 1 projects.
- 6. Schematic Design (SD) Board Presentation** May 16, 2017
  - BCA's team will present the final SD phase scope/designs for phase 1 projects.

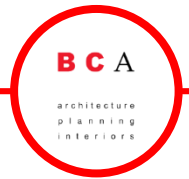

**Priority 1:** 21st Century Classrooms and upgrades to portables, AB300 [DSA will require it to be in this phase], ADA, electrical gear/service upgrades, abatement, restroom and ADA upgrades, roof replacement, plaster repair at Dwyer.

**Priority 2:** Multipurpose and STEAM Labs at the [2] Middle Schools, LED lighting and lighting controls, air conditioning and controls, new playground at Smith, Admin. rework, replace concealed spline ceilings at Sowers, upgrade Auditorium at Dwyer.

**Priority 3:** Learning Commons.

**Priority 4:** Safety and security single point of entry/exit at Admin., site fencing, remove/modify walkway canopies, restrict roof access, and portables to permanent.

# Measure Q Phasing by Priority

---



**Phase 1** (Priority 1 & 2) **2017-2020** (3 years)

**Phase 2** (Priority 1 & 2) **2020-2023** (3 years)

**Phase 3** (Priority 2 & 3) **2023-2026** (3 years)

**Phase 4** (Priority 3 & 4) **2026-2029** (3 years)

---

**Measure Q Bond Program** **2017-2029** (12 years)



<b>2017-2020 Phase 1:</b>	<b>\$50,000,000</b> (initial projection \$57M)
2020-2023 Phase 2:	\$49,850,000 (initial projection \$53M)
2023-2026 Phase 3:	\$30,000,000 (initial projection \$13.85M)
<u>2026-2029 Phase 4:</u>	<u>\$30,000,000</u> (initial projection \$36M)
<b>2017-2029 TOTAL:</b>	<b>\$159,850,000</b>

- Complete (1) demonstration classroom at each campus during the 2017 summer.
- Complete all life safety projects in the first phase.
- Complete new Middle School STEM labs and gym/multi-purpose projects in the first phase to allow all HBCSD students to engage in these state of the art environments as quickly as possible.
- Complete 21<sup>st</sup> century classroom renovations District wide in the first two phases.

# Measure Q Bond Projects HAWES ELEMENTARY SCHOOL

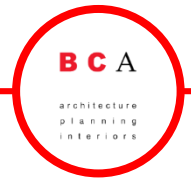

Hawes Elementary School - Measure Q Bond Projects	Phase 1 (2017-2020)	Phase 2 (2020-2023)	Phase 3 (2023-2026)	Phase 4 (2026-2029)
(1) Demonstration Classroom	\$ 85,000			
21st Century Classroom Renovations	\$ 3,000,000			
21st Century Portable Renovations	\$ 600,000			
Electrical Upgrades	\$ 500,000			
AB 300 upgrades	\$ 2,000,000			
Façade Improvements				\$ 1,000,000
Covered Walkways				\$ 1,000,000
Free Standing Shade Structure			\$ 1,000,000	
Upgrade Lighting to LED Commons)			\$ 500,000	
				\$ 5,500,000
Subtotal	\$ 6,185,000	\$ -	\$ 1,500,000	\$ 7,500,000
Contingency (10%)	\$ 618,500	\$ -	\$ 150,000	\$ 750,000
Construction Escalation (4% per year)	\$ 268,400	\$ -	\$ 462,000	\$ 3,300,000
<b>TOTAL ESTIMATED HARD CONSTRUCTION COST</b>	<b>\$ 7,071,900</b>	<b>\$ -</b>	<b>\$ 2,112,000</b>	<b>\$ 11,550,000</b>

\*The estimates above are conceptual budget estimates – project cost will be refined after further analysis

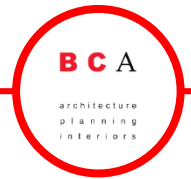

<b>Schematic Design</b>	<b>April 17 – May 17</b>
<b>Design Development</b>	<b>May 17 – July 17</b>
<b>Construction Documents</b>	<b>July 17 – Aug 17</b>
<b>DSA Review</b>	<b>Aug 17 – Feb 18</b>
<b>Bidding</b>	<b>Feb 18 – March 18</b>
<b>Construction</b>	<b>June 18 – Aug 18</b>

# Modernization

Hawes Elementary School Phase 1 Schematic Design



## PROJECT SCOPE:

- **21st Century Classroom Renovations (23 Classrooms)**
- **21st Century Portable Renovations (8 Portable Classrooms)**
- **Site Electrical Infrastructure:**
- **Site Accessibility Upgrades**
- **Restroom Accessibility Upgrades**
- **Seismic Retrofit Upgrades**

# PROJECT SCOPE

## General

The Hawes site is generally flat with mild slope up from the surrounding street. No other issues with access to the perimeter of the building.

## Accessible Path Of Travel

### 21st Century Classroom Renovations (23 Classrooms)

- Electrical (The District will be finalizing the various classroom technology components make/model and locations in January 2018, after receiving feedback from the demonstration classroom process. The design work for the scope below will be completed during DSA review and integrated into the plans during DSA backcheck.):
  - New 120 Volt power outlets as shown on 'Hawes Typical Classroom Electrical Exhibit' sketch.
  - Rough in boxes in walls for audio/video/computer systems as shown on 'Hawes Typical Classroom Electrical Exhibit' sketch. Provide conduit only from rough in boxed to above ceiling.
- Existing Ceilings:
  - Existing T-Bar Grid to remain and be painted; confirm existing suspended ceiling system complies with the current code or, if not, can the existing suspended ceiling system be modified to meet current code; if not, DSA will likely require a new suspended ceiling system
  - Remove existing ceiling tiles and install new acoustical ceiling tiles (confirm MFR)
- Install floor to ceiling magnetic dry erase board panels, centered on projector wall
- Concrete wall furring for walls where magnetic dry erase board will be installed at existing concrete walls.
- Concrete wall furring for walls where vinyl tackable panels will be installed at existing concrete walls.
- Paint existing walls that do not receive magnetic dry erase or tackable wall panels
- Remove existing flooring and install new carpet flooring

### 21st Century Portable Renovations (8 Portable Classrooms):

- Surface mounted boxes in walls for audio/video/computer systems as shown on 'Typical Portable Classroom Electrical Exhibit' sketch. Provide surface mounted conduit only from boxed to above ceiling.
- Remove existing flooring and install new carpet flooring.

### Site Infrastructure:

- Electrical:
  - New switch gear and electrical infrastructure.
  - New campus wide PA/bell/clock system and Voice Over IP.
  - Evaluate existing campus MDF, IDF and cabling and recommend if upgrades are required.

### Accessibility upgrades:

- AREA 1: [See photo 033]: Access way to the site from the City sidewalk requires truncated domes.
- AREA 2: [See photo 034, 035]: Accessible spaces are too short and require signage update. Area will require asphalt rework to obtain max. cross slopes, need to remove speed bump. Access to the sidewalk goes behind a car and will require restriping. Need to add a van space. Add truncated domes to curb ramp.
- AREA 3: [See photo 036]: Bus drop off requires new striping and signage as well as accessible ramps.
- AREA 4: [See photo 037]: Need to add truncated domes.
- AREA 5: [See photo 038]: Two existing accessible spaces require signage, need to add a van space.



## SITE PLAN SCHEMATIC DESIGN

Hawes Elementary School Modernization  
04-24-2017

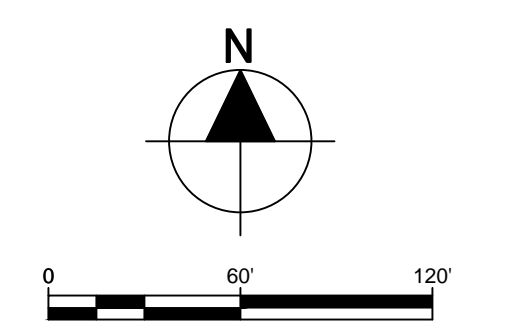

**BCA**  
architecture  
planning  
interiors  
305 South Market Street  
San Jose, California 95113  
415.435.8800  
www.bcaarchitect.com

(A)

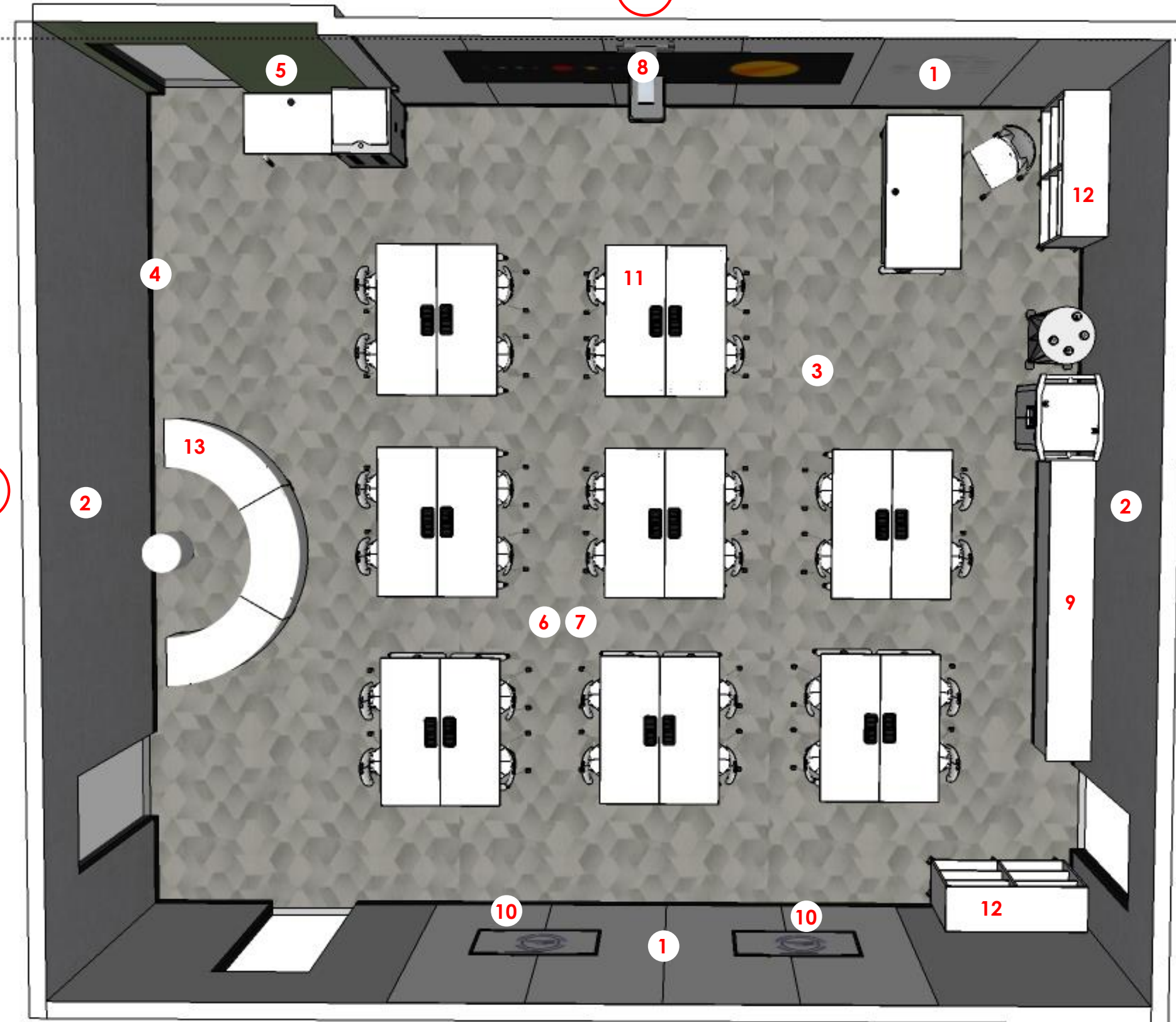

## PROJECT SCOPE

1. Floor to ceiling magnetic dry erase surface (furred walls to conceal conduit)
2. Floor to ceiling vinyl tack-board (furred walls to conceal conduit)
3. New carpet
4. New wall base
5. New paint
6. New acoustical ceiling tiles
7. Paint existing T-bar ceiling grid
8. Interactive multi-touch projector
9. Existing casework with sink to remain
10. LCD display
11. Agile furniture
12. Agile storage
13. Soft seating

**Note: Final furniture and technology will be determined during the collaborative demonstration classroom process**

(C)

# TYPICAL CLASSROOM FLOOR PLAN SCHEMATIC DESIGN

PROJECT 5 - Hawes Elementary School Modernization  
04/24/2017

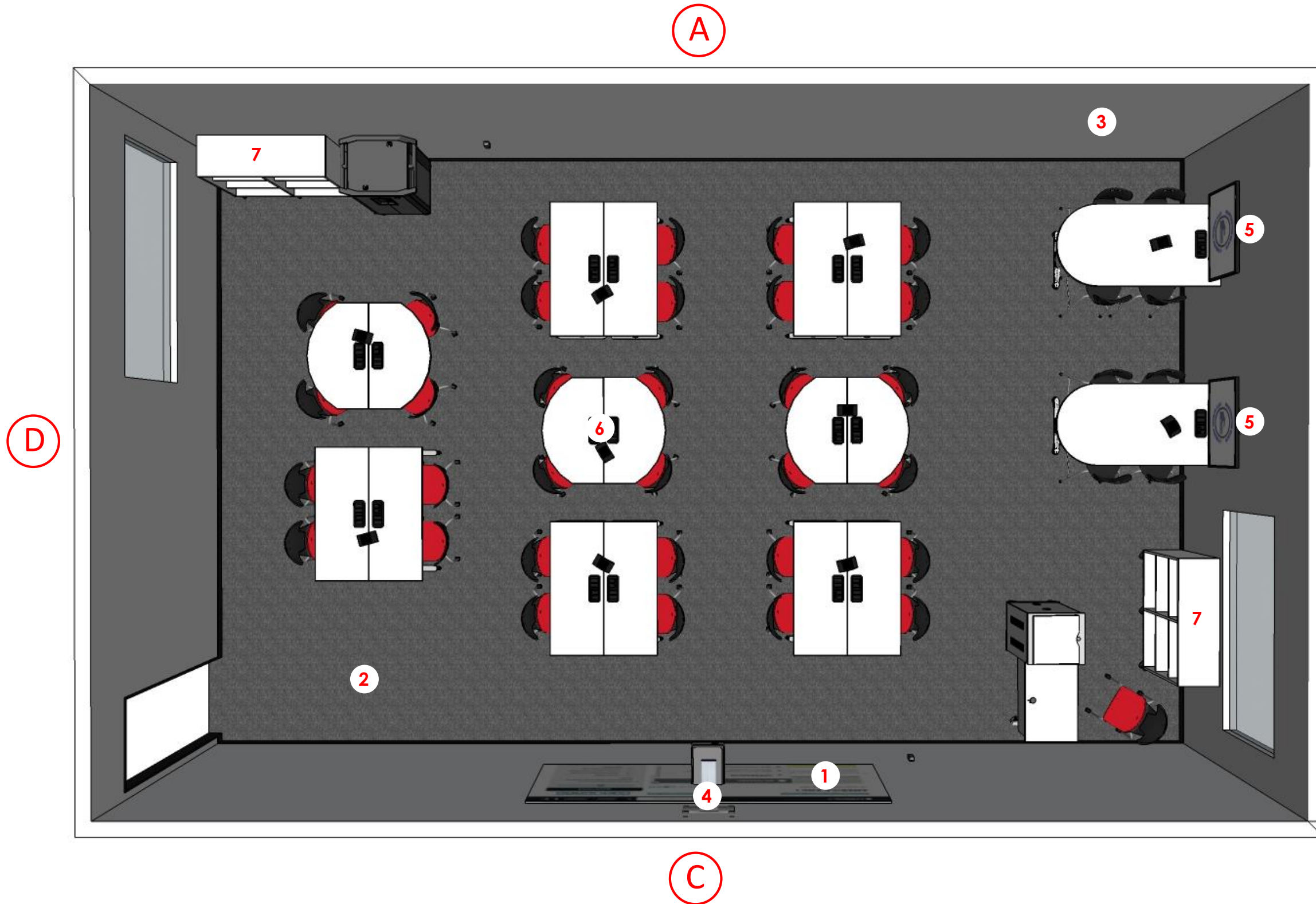

## PROJECT SCOPE

1. 5' x 16' magnetic dry erase board
2. New carpet
3. New paint, existing wall surface to remain
4. Interactive multi-touch projector
5. LCD display
6. Agile furniture
7. Agile storage

**Note: Final furniture and technology will be determined during the collaborative demonstration classroom process**

# TYPICAL PORTABLE CLASSROOM FLOOR PLAN SCHEMATIC DESIGN

PROJECT 5 – Hawes Elementary School Modernization  
04/24/2017

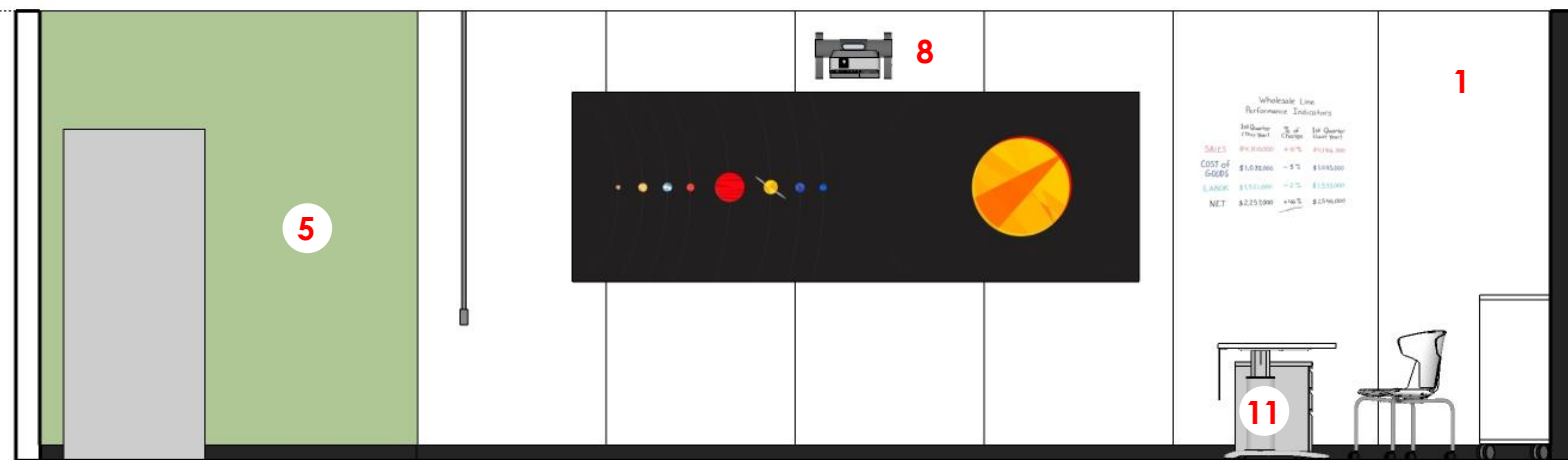

A

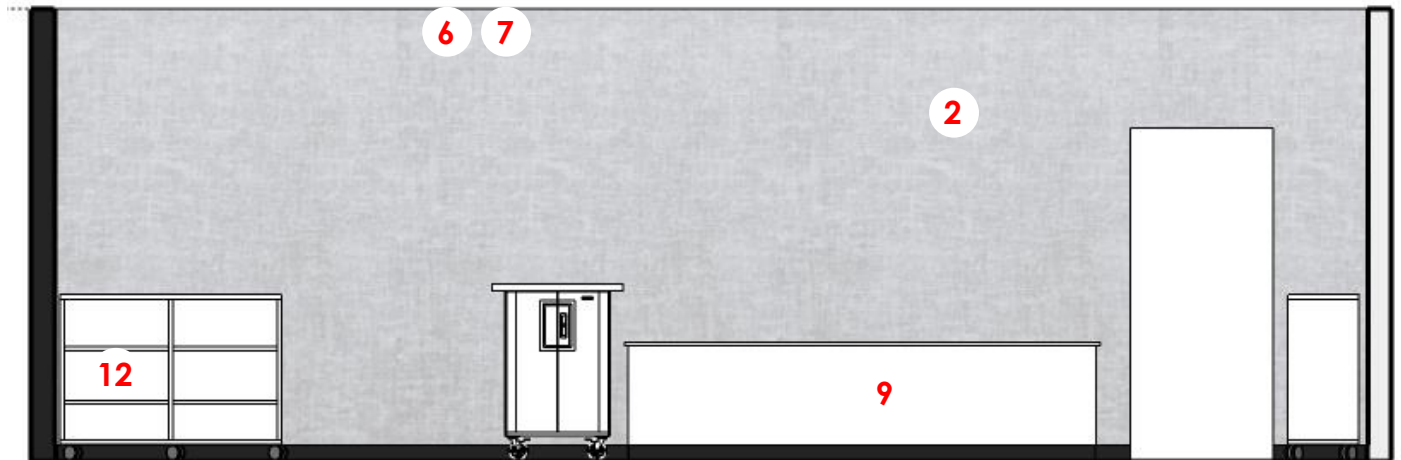

B

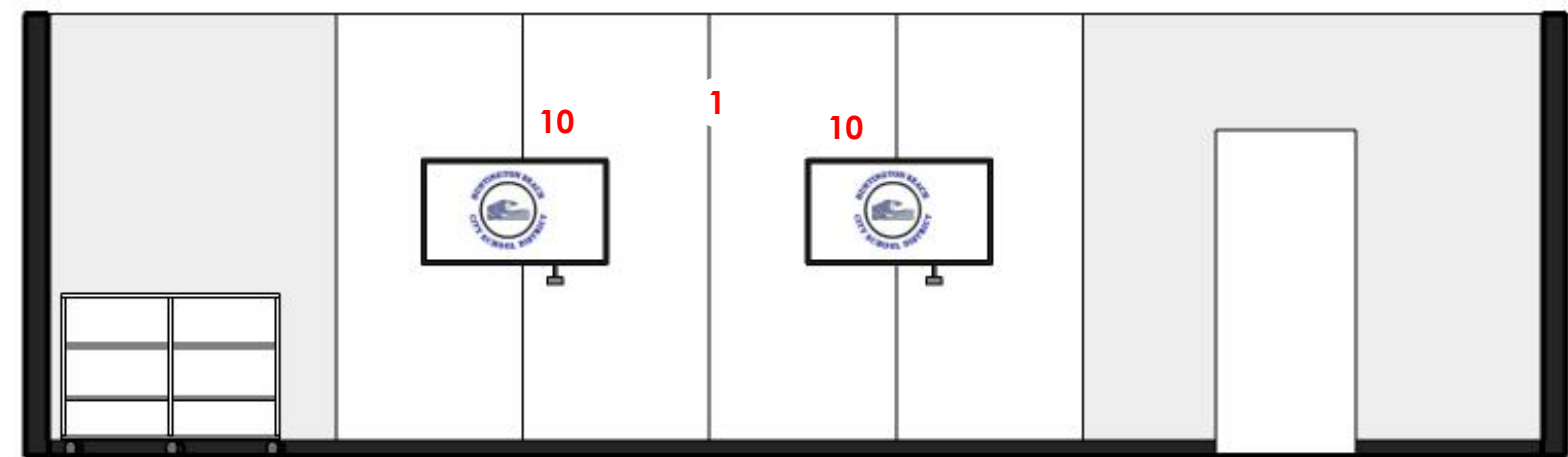

C

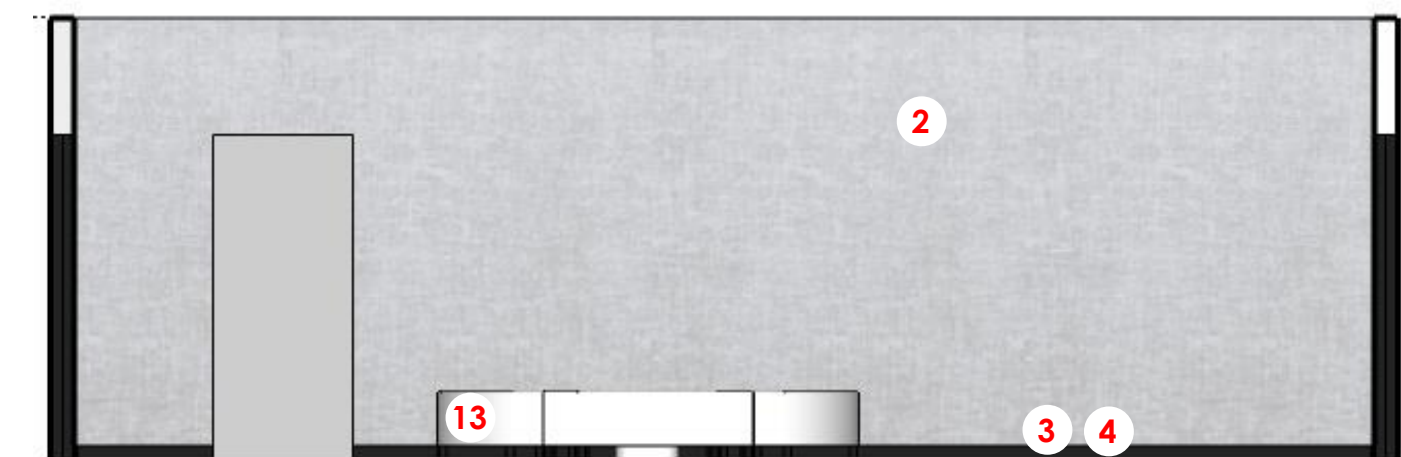

D

## PROJECT SCOPE

- |  |  |
|--|--|
| 1. Floor to ceiling magnetic dry erase surface (furred walls to conceal conduit) | 8. Interactive multi-touch projector     |
| 2. Floor to ceiling vinyl tack-board (furred walls to conceal conduit)           | 9. Existing casework with sink to remain |
| 3. New carpet  | 10. LCD display                          |
| 4. New wall base   | 11. Agile furniture                      |
| 5. New paint   | 12. Agile storage                        |
| 6. New acoustical ceiling tiles  | 13. Soft seating                         |
| 7. Paint existing t-bar ceiling grid   |  |

**Note: Final furniture and technology will be determined during the collaborative demonstration classroom process**

# TYPICAL CLASSROOM INTERIOR ELEVATIONS SCHEMATIC DESIGN

PROJECT 5 - Hawes Elementary School Modernization  
04/24/2017



A

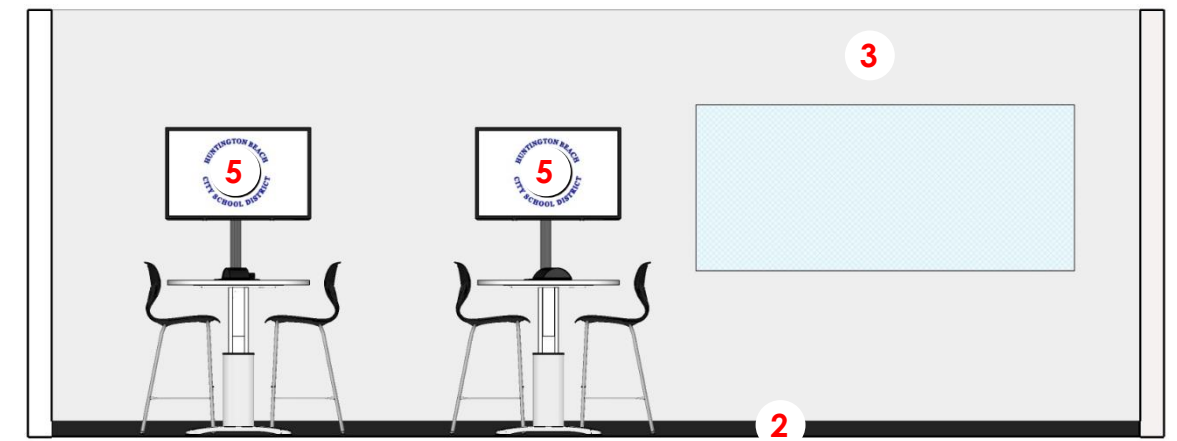

B

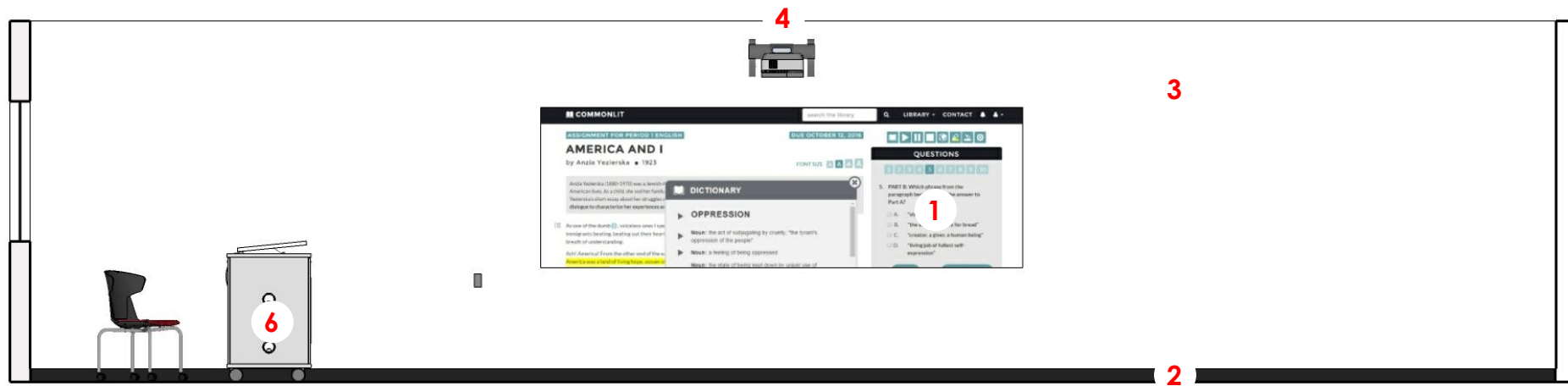

C

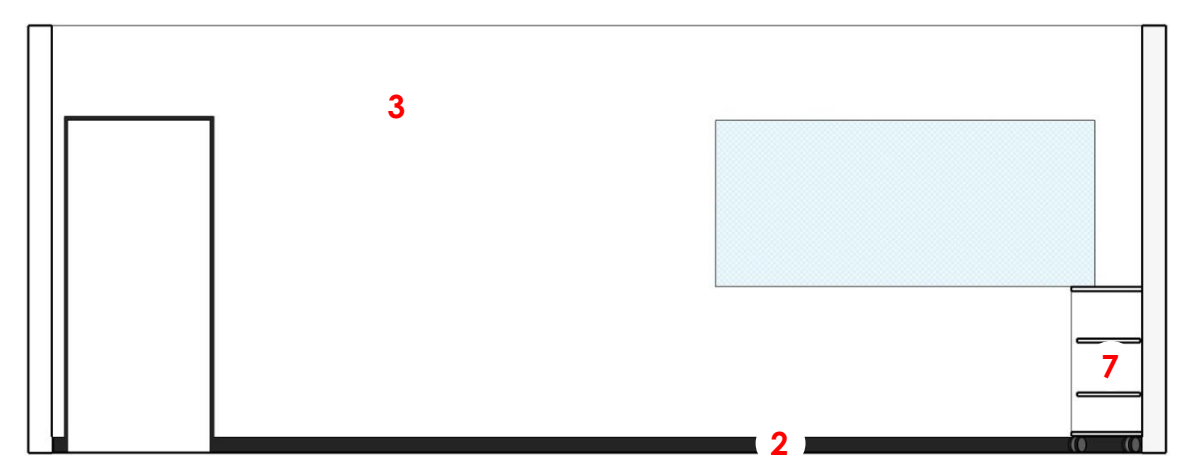

D

## PROJECT SCOPE

- |   |                    |
|---|--------------------|
| 1. 5' x 16' magnetic dry erase board          | 5. LCD display     |
| 2. New carpet                                 | 6. Agile furniture |
| 3. New paint, existing wall surface to remain | 7. Agile storage   |
| 4. Interactive multi-touch projector          |                    |

**Note: Final furniture and technology will be determined during the collaborative demonstration classroom process**

# TYPICAL PORTABLE CLASSROOM ELEVATIONS SCHEMATIC DESIGN

PROJECT 5 – Hawes Elementary School Modernization  
04/24/2017

# Q & A

