



# Huntington Beach City School District



- 1. Where are we in the process?**
- 2. Measure Q Bond Program Updates**
- 3. District Wide Priorities**
- 4. Measure Q Phasing by Priority**
- 5. Campus Projects & Phasing**
- 6. Schedule**
- 7. Phase 1 Schematic Design**

# Where are we in the process?

---

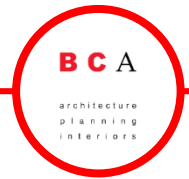

- 1. Project Prioritization Site Meetings** January 10-11, 2017
  - BCA's team held site meetings to review the Bond Program planned projects for each campus.
- 2. Project Prioritization Board Presentation** January 17, 2017
  - BCA's team presented the overall project prioritization for the Measure Q Bond Program.
- 3. Demonstration Classroom Teacher Meeting** March 28, 2017
  - OnPoint presented the designs for each of the (12) demonstration classrooms.
- 4. Phase 1 Schematic Design (SD) Phase** April 17, 2017
  - BCA began the SD phase for the phase 1 projects.
- 5. Schematic Design (SD) Site Committee Meetings** May 3 - 5, 2017
  - BCA's team will meet with each campus' site committee to review the SD phase scope/designs for phase 1 projects.
- 6. Schematic Design (SD) Board Presentation** May 16, 2017
  - BCA's team will present the final SD phase scope/designs for phase 1 projects.

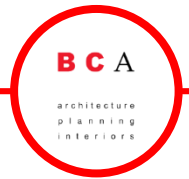

**Priority 1:** 21st Century Classrooms and upgrades to portables, AB300 [DSA will require it to be in this phase], ADA, electrical gear/service upgrades, abatement, restroom and ADA upgrades, roof replacement, plaster repair at Dwyer.

**Priority 2:** Multipurpose and STEAM Labs at the [2] Middle Schools, LED lighting and lighting controls, air conditioning and controls, new playground at Smith, Admin. rework, replace concealed spline ceilings at Sowers, upgrade Auditorium at Dwyer.

**Priority 3:** Learning Commons.

**Priority 4:** Safety and security single point of entry/exit at Admin., site fencing, remove/modify walkway canopies, restrict roof access, and portables to permanent.

# Measure Q Phasing by Priority

---



**Phase 1** (Priority 1 & 2) **2017-2020** (3 years)

**Phase 2** (Priority 1 & 2) **2020-2023** (3 years)

**Phase 3** (Priority 2 & 3) **2023-2026** (3 years)

**Phase 4** (Priority 3 & 4) **2026-2029** (3 years)

---

**Measure Q Bond Program** **2017-2029** (12 years)



<b>2017-2020 Phase 1:</b>	<b>\$50,000,000</b> (initial projection \$57M)
2020-2023 Phase 2:	\$49,850,000 (initial projection \$53M)
2023-2026 Phase 3:	\$30,000,000 (initial projection \$13.85M)
<u>2026-2029 Phase 4:</u>	<u>\$30,000,000</u> (initial projection \$36M)
<b>2017-2029 TOTAL:</b>	<b>\$159,850,000</b>

- Complete (1) demonstration classroom at each campus during the 2017 summer.
- Complete all life safety projects in the first phase.
- Complete new Middle School STEM labs and gym/multi-purpose projects in the first phase to allow all HBCSD students to engage in these state of the art environments as quickly as possible.
- Complete 21<sup>st</sup> century classroom renovations District wide in the first two phases.

# Measure Q Bond Projects MOFFETT ELEMENTARY SCHOOL

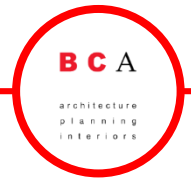

Moffett Elementary School - Measure Q Bond Projects	Phase 1 (2017-2020)	Phase 2 (2020-2023)	Phase 3 (2023-2026)	Phase 4 (2026-2029)
(2) Demonstration Classrooms	\$ 170,000			
21st Century Classroom Renovations		\$ 3,600,000		
AB 300 upgrades		\$ 2,000,000		
Library to Learning Commons & Administration Renovation		\$ 150,000		
Façade Improvements				\$ 1,000,000
Covered Walkways				\$ 1,000,000
Free Standing Shade Structure			\$ 1,000,000	
Portables to Permanent				\$ 1,500,000
Subtotal	\$ 170,000	\$ 5,750,000	\$ 1,000,000	\$ 3,500,000
Contingency (10%)	\$ 17,000	\$ 575,000	\$ 100,000	\$ 350,000
Construction Escalation (4% per year)	\$ 3,740	\$ 1,012,000	\$ 308,000	\$ 1,540,000
<b>TOTAL ESTIMATED HARD CONSTRUCTION COST</b>	<b>\$ 190,740</b>	<b>\$ 7,337,000</b>	<b>\$ 1,408,000</b>	<b>\$ 5,390,000</b>

\*The estimates above are conceptual budget estimates – project cost will be refined after further analysis

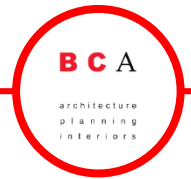

<b>Schematic Design</b>	<b>April 17 – May 17</b>
<b>Design Development</b>	<b>May 17 – July 17</b>
<b>Construction Documents</b>	<b>July 17 – Aug 17</b>
<b>DSA Review</b>	<b>Aug 17 – Feb 18</b>
<b>Bidding</b>	<b>Jan 21 – Feb 21</b>
<b>Construction</b>	<b>June 21 – Aug 21</b>

# Modernization

Moffett Elementary School Phase 1 Schematic Design



## PROJECT SCOPE:

- **21st Century Classroom Renovations (25 Classrooms)**
- **Library to Learning Commons & Administration Renovation**
- **Site Electrical Infrastructure:**
- **Site Accessibility Upgrades**
- **Restroom Accessibility Upgrades**
- **Seismic Retrofit Upgrades**

# PROJECT SCOPE

## General

The Moffett campus is generally flat with some slope up to the walk areas from the adjacent streets. No other site related issues to the perimeter of the building.

----- Accessible Path of travel

## 21<sup>st</sup> Century Classroom Renovations (25 Classrooms)

- Electrical (The District will be finalizing the various classroom technology components make/model and locations in January 2018, after receiving feedback from the demonstration classroom process. The design work for the scope below will be completed during DSA review and integrated into the plans during DSA backcheck.):
  - New 120 Volt power outlets as shown on 'Moffett Typical Classroom Electrical Exhibit' sketch.
  - Rough in boxes in walls for audio/video/computer systems as shown on 'Moffett Typical Classroom Electrical Exhibit' sketch. Provide conduit only from rough in boxed to above ceiling.
- Existing Ceilings:
  - Existing T-Bar Grid to remain and be painted; confirm existing suspended ceiling system complies with the current code or, if not, can the existing suspended ceiling system be modified to meet current code; if not, DSA will likely require a new suspended ceiling system
  - Remove existing ceiling tiles and install new acoustical ceiling tiles (confirm MFR)
- Install floor to ceiling magnetic dry erase board panels, centered on projector wall
- Concrete wall furring for walls where magnetic dry erase board will be installed at existing concrete walls.
- Concrete wall furring for walls where vinyl tackable panels will be installed at existing concrete walls.
- Paint existing walls that do not receive magnetic dry erase or tackable wall panels
- Remove existing flooring and install new carpet flooring

## Library to Learning Commons Renovations

- Electrical upgrades (The District will be finalizing the various classroom technology components make/model and locations in January 2018, after receiving feedback from the demonstration classroom process. The design work for the scope below will be completed during DSA review and integrated into the plans during DSA backcheck.):
  - New 120 Volt power outlets as shown on 'Moffett Typical Classroom Electrical Exhibit' sketch.
  - Rough in boxes in walls for Audio/Video/Computer systems as shown on 'Moffett Typical Classrooms Exhibit' sketch. Provide conduit only from rough in boxed to above ceiling.
- Existing Ceilings:
  - Existing T-Bar Grid to remain and be painted; confirm existing suspended ceiling system complies with the current code or, if not, can the existing suspended ceiling system be modified to meet current code; if not, DSA will likely require a new suspended ceiling system.
  - Remove existing ceiling tiles and install new acoustical ceiling tiles (confirm MFR)
- Install floor to ceiling magnetic dry erase board.
- Paint existing walls that do not receive magnetic dry erase board.
- Remove existing flooring and install new carpet flooring

## Site Infrastructure

- Electrical:
  - New switch gear and electrical infrastructure.
  - New campus wide PA/bell/clock system and Voice Over IP.
  - Evaluate existing campus MDF, IDF and cabling and recommend if upgrades are required.

## Accessibility Site Upgrades

- AREA 1: [See photo 39] Two accessible spaces require signage update and slurry work/restriping to attain max. cross slope.
- AREA 2: [See photo 40]: A passenger drop off with accessible zero curb area will be added to the drop-off lane.
- AREA 3: [See photo 42, 43]: Restripe bus drop off area.
- AREA 4: [See photo 44, 45]: Accessible parking needs rework since striped access to the curb ramp runs behind a car. Will need a new relocated curb ramp, restriping, signage and a van space.

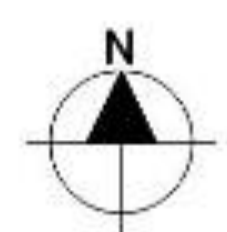
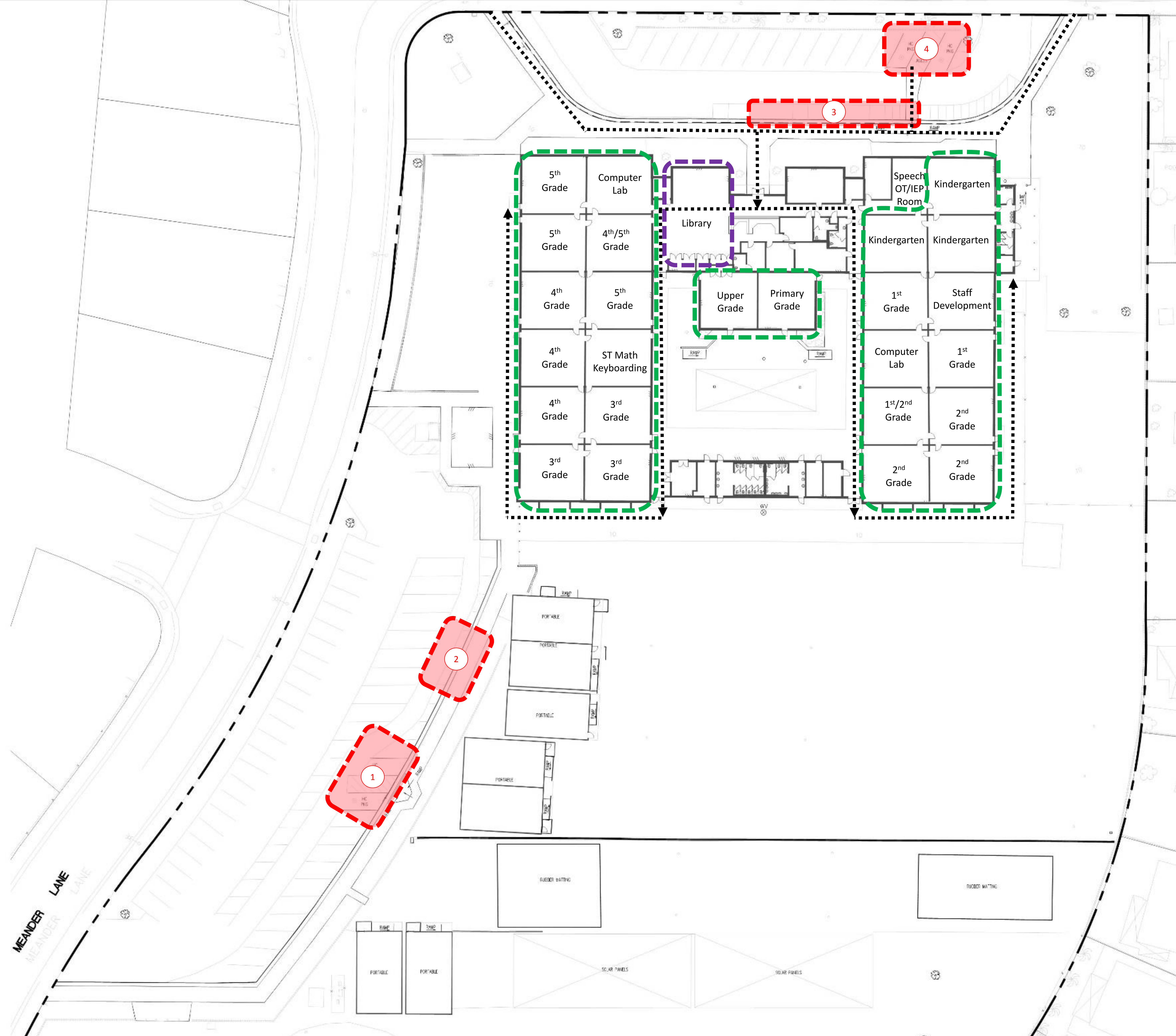

(A)

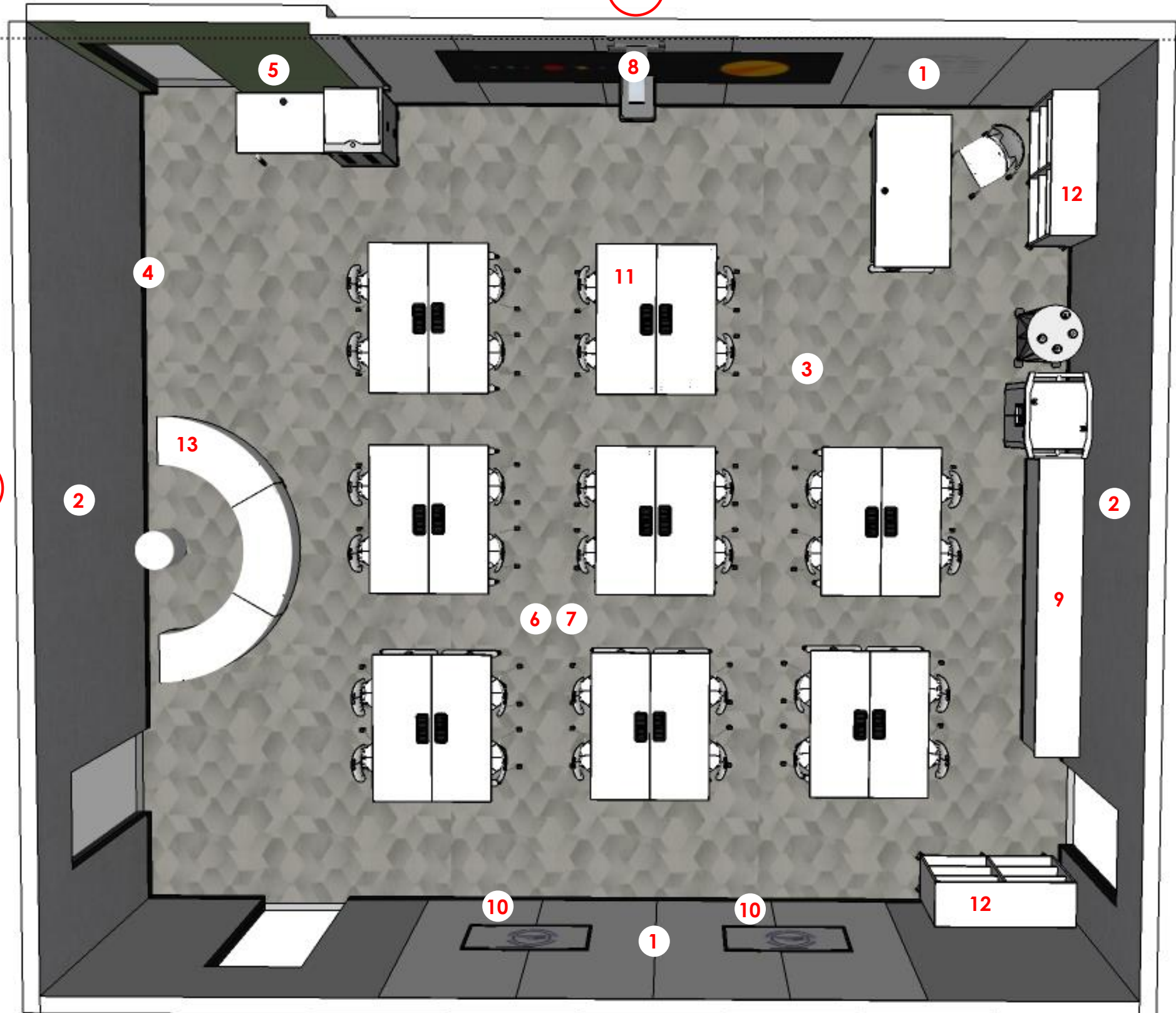

## PROJECT SCOPE

1. Floor to ceiling magnetic dry erase surface (furred walls to conceal conduit)
2. Floor to ceiling vinyl tack-board (furred walls to conceal conduit)
3. New carpet
4. New wall base
5. New paint
6. New acoustical ceiling tiles
7. Paint existing T-bar ceiling grid
8. Interactive multi-touch projector
9. Existing casework with sink to remain
10. LCD display
11. Agile furniture
12. Agile storage
13. Soft seating

**Note: Final furniture and technology will be determined during the collaborative demonstration classroom process**

(C)

# TYPICAL CLASSROOM FLOOR PLAN SCHEMATIC DESIGN

PROJECT 6 - Moffett Elementary School Modernization  
04/24/2017

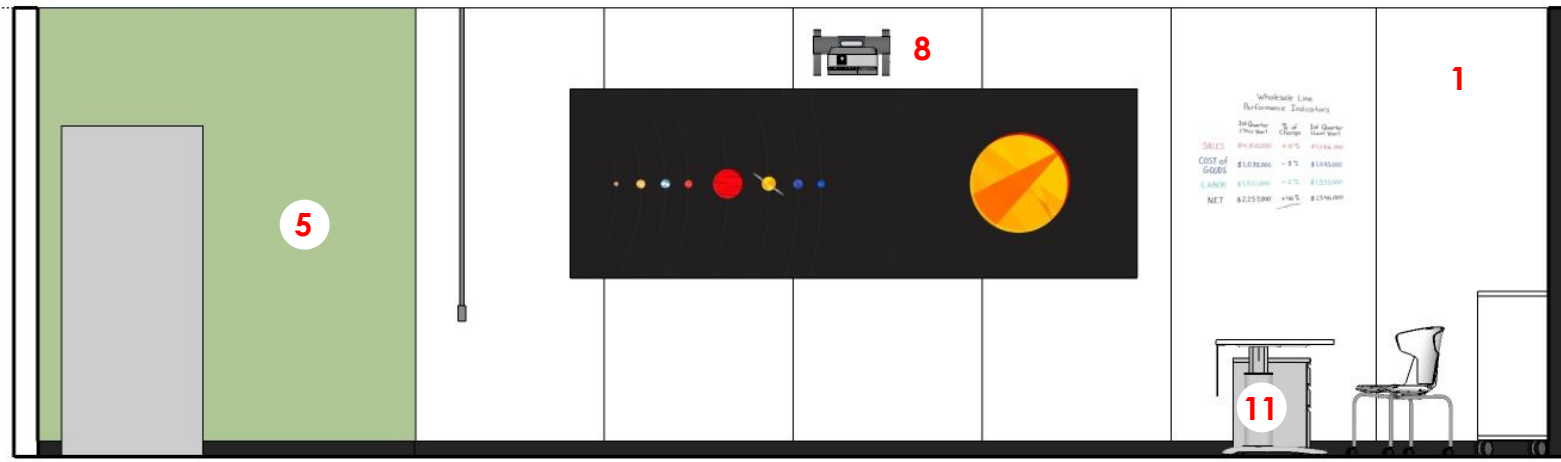

A

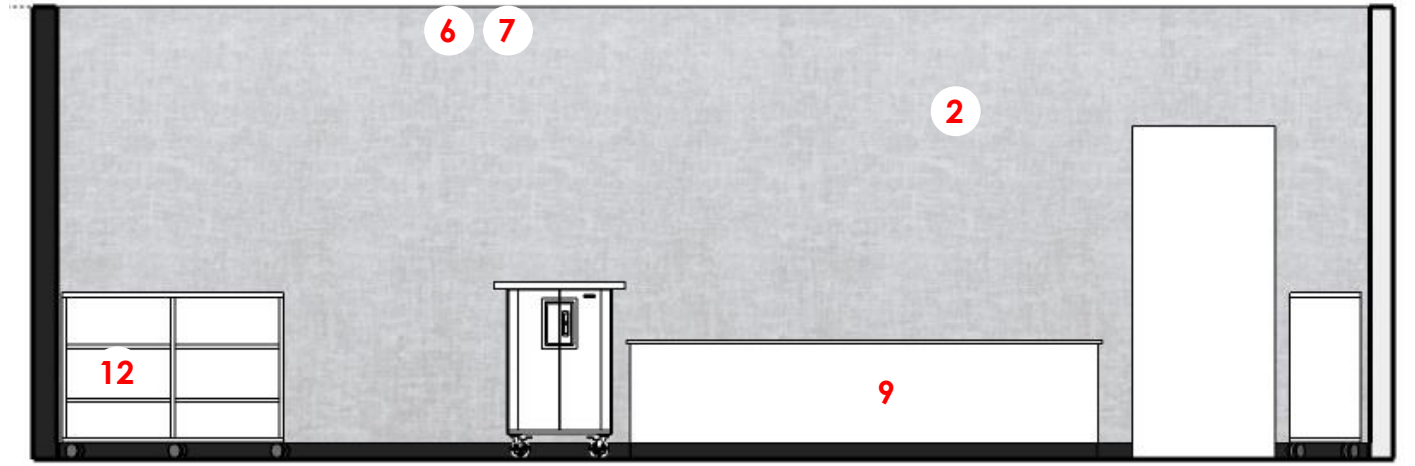

B

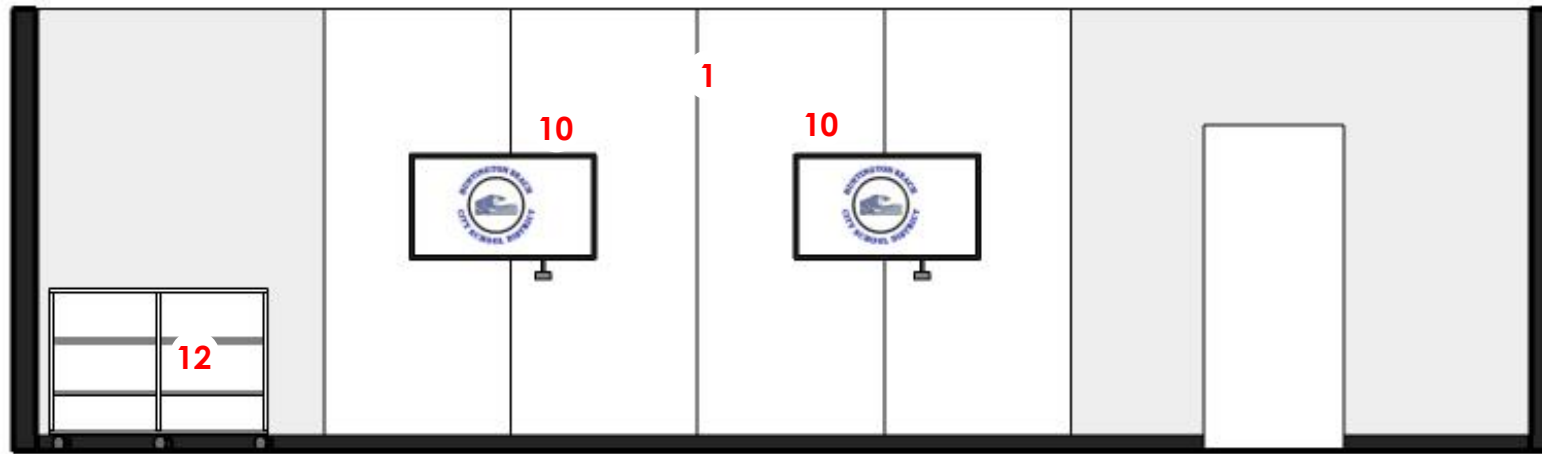

C

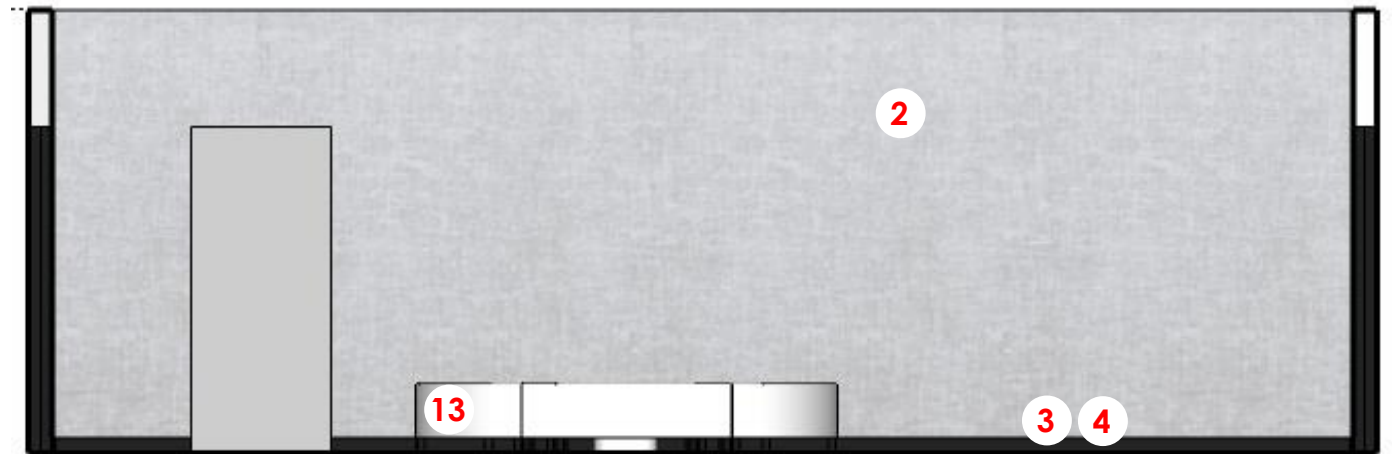

D

## PROJECT SCOPE

- |  |  |
|--|--|
| 1. Floor to ceiling magnetic dry erase surface (furred walls to conceal conduit) | 8. Interactive multi-touch projector     |
| 2. Floor to ceiling vinyl tack-board (furred walls to conceal conduit)           | 9. Existing casework with sink to remain |
| 3. New carpet  | 10. LCD display                          |
| 4. New wall base   | 11. Agile furniture                      |
| 5. New paint   | 12. Agile storage                        |
| 6. New acoustical ceiling tiles  | 13. Soft seating                         |
| 7. Paint existing t-bar ceiling grid   |  |

Note: Final furniture and technology will be determined during the collaborative demonstration classroom process

# TYPICAL CLASSROOM INTERIOR ELEVATIONS SCHEMATIC DESIGN

PROJECT 6 - Moffett Elementary School Modernization  
04/24/2017

# Q & A

