



# Huntington Beach City School District

---



Conceptual District Vision – Peterson Elementary School Site Presentation

- 1. Background of Completed Facilities Needs Assessments**
- 2. Overview of District Wide Recommended Priorities**
- 3. Preliminary Goals and Objectives**
- 4. Existing Campus Conditions**
- 5. Model Classroom and School, 21st Century Learning Overview**
- 6. Q&A**

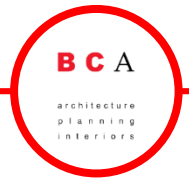

- 1. Site Visits Were Conducted on 8/3/16 to Understand the District's Campuses**
- 2. BCA Analyzed Findings From the Site Visits**
- 3. Preliminary Priorities For Each Campus Were Established with the Superintendent and Multiple Members of the M&O Staff.**
- 4. Completed Facilities Needs Assessment Reports that Summarized BCA Findings and Recommendations**

**Priority 1:** 21st Century Classrooms and upgrades to portables, AB300 [DSA will require it to be in this phase], ADA, electrical gear/service upgrades, abatement, restroom and ADA upgrades, roof replacement, plaster repair at Dwyer.

**Priority 2:** Multipurpose and STEAM Labs at the [2] Middle Schools, LED lighting and lighting controls, air conditioning and controls, new playground at Smith, Admin. rework, replace concealed spline ceilings at Sowers, upgrade Auditorium at Dwyer.

**Priority 3:** Learning Commons.

**Priority 4:** Safety and security single point of entry/exit at Admin., site fencing, remove/modify walkway canopies, restrict roof access, and portables to permanent.

1. Modernize Classrooms and Create 21<sup>st</sup> Century Standard for Huntington Beach City SD.
2. Code, Health, Infrastructure, Safety and Security.
3. Creating 21<sup>st</sup> Century Learning Environments.
  - Outdoor Learning, Maker's Labs, STEAM Labs, Learning commons
4. Repurpose Buildings/Rooms where necessary

# Existing Campus Conditions PETERSON ELEMENTARY SCHOOL

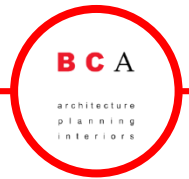

## Campus Analysis

Site	15.42 acres
Year Built	1961
Last Modified	2001
Grade Levels	Preschool, TK-5
Permanent Classrooms	31
Portable Classrooms	4
Special Ed., CLAPP	9 of 31
YMCA Portable	1 [owned by YMCA]

## Campus Capacity

Current Enrollment	723
Permanent Classroom Capacity	868 [28 students / classroom]
Permanent Classrooms Needed	0

## Summary of Findings

- New transformer, switch gear and electrical infrastructure needed.
- CLAPP wing façade needs update.
- North parking lot needs to be reconstructed.
- District food service space is moving to Kettler, repurpose food service space and provide small warming kitchen.
- Restrooms in CLAPP wing require ADA upgrade and ceiling repair.
- Add parking stalls in adjacent lot.
- Site access control/fencing required.
- Need new clocks, phones, and bells.
- Lighting is not Title 24 compliant, provide interior LED fixtures. Exterior LED fixtures complete.
- There is no air conditioning, District is adding fans.



## “Good”

- 1 Interactive Display
- Rectangular Desks
- White Board Wall



## “Better”

- 2 Interactive Displays (1 Display and 1 Interactive White Board)
- Triangular Desks
- Soft Seating

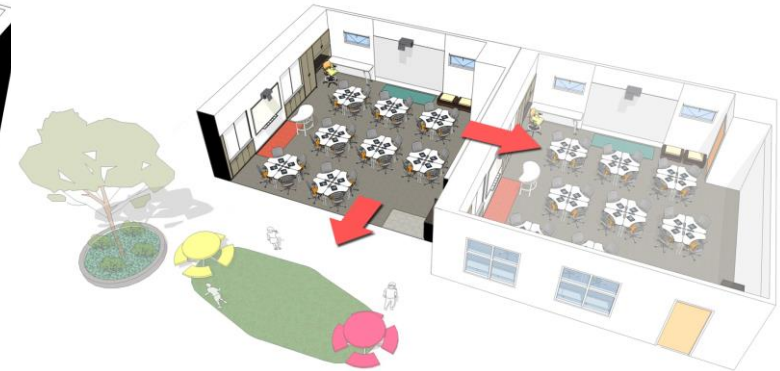

## “Best”

- 2 Interactive Displays (1 Display and 1 Interactive White Board)
- Triangular Desks & Soft Seating
- Nanowalls between Classrooms
- Sliding Doors that open up to Outdoor Learning

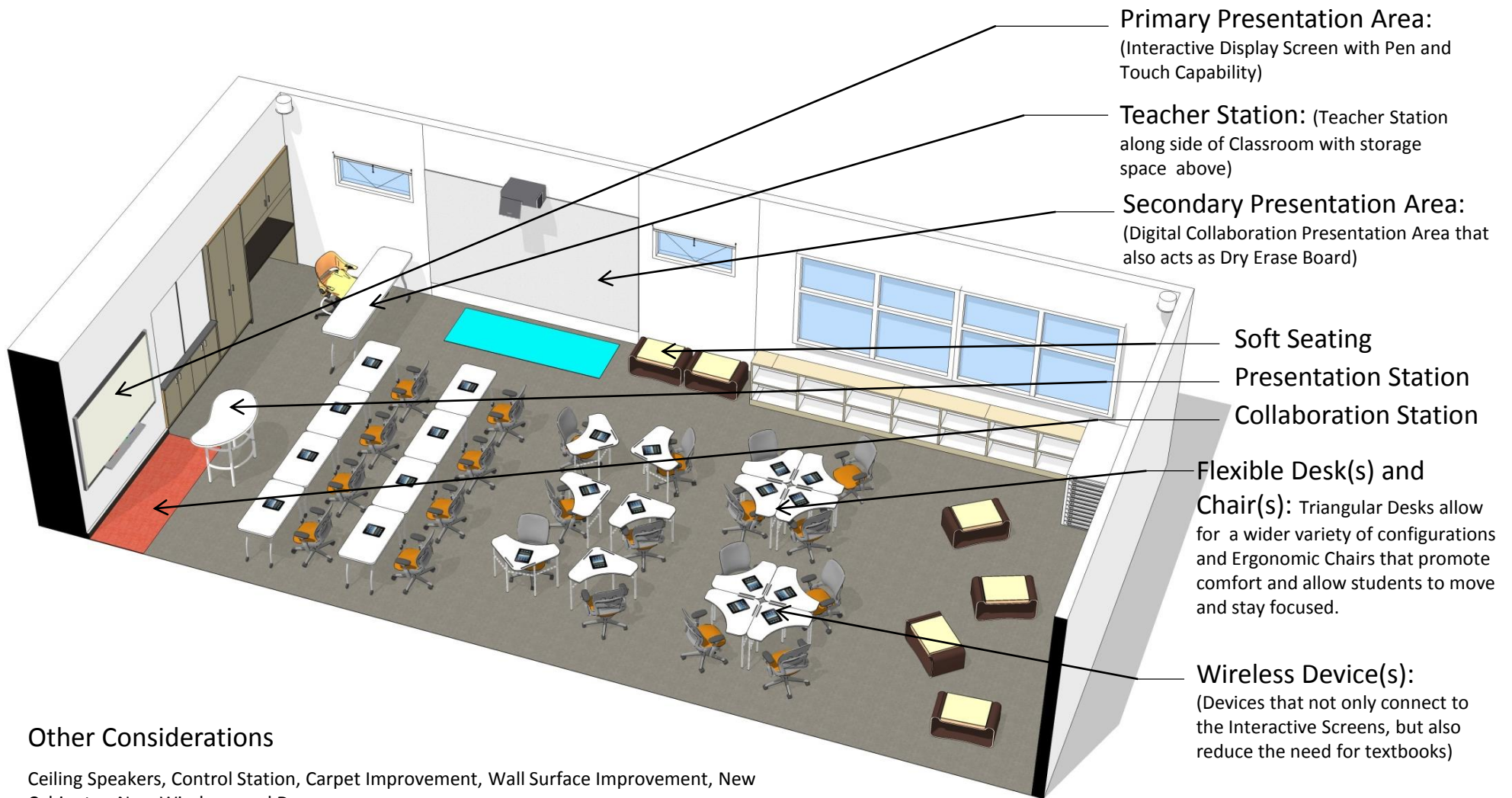

**Primary Presentation Area:**  
(Interactive Display Screen with Pen and Touch Capability)

**Teacher Station:** (Teacher Station along side of Classroom with storage space above)

**Secondary Presentation Area:**  
(Digital Collaboration Presentation Area that also acts as Dry Erase Board)

**Soft Seating**

**Presentation Station**

**Collaboration Station**

**Flexible Desk(s) and Chair(s):** Triangular Desks allow for a wider variety of configurations and Ergonomic Chairs that promote comfort and allow students to move and stay focused.

**Wireless Device(s):**  
(Devices that not only connect to the Interactive Screens, but also reduce the need for textbooks)

## Other Considerations

Ceiling Speakers, Control Station, Carpet Improvement, Wall Surface Improvement, New Cabinetry, New Windows and Doors.

# BCA Model School LEARNING COMMONS

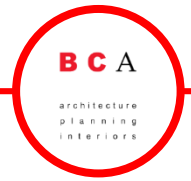

# BCA Model School OUTDOOR LEARNING





The Makers Learning Labs allow students to collaborate and work together on various projects. The Makers Labs fit into 21<sup>st</sup> Century Learning due to the flexibility in its structure and the ways in which it allows students to learn from one another.



# BCA Model School BUENA PARK DEMONSTRATION CLASSROOM

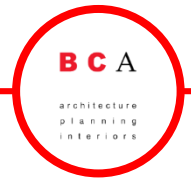

# BCA Model School DARTMOUTH STEM LAB



\* Middle Schools only

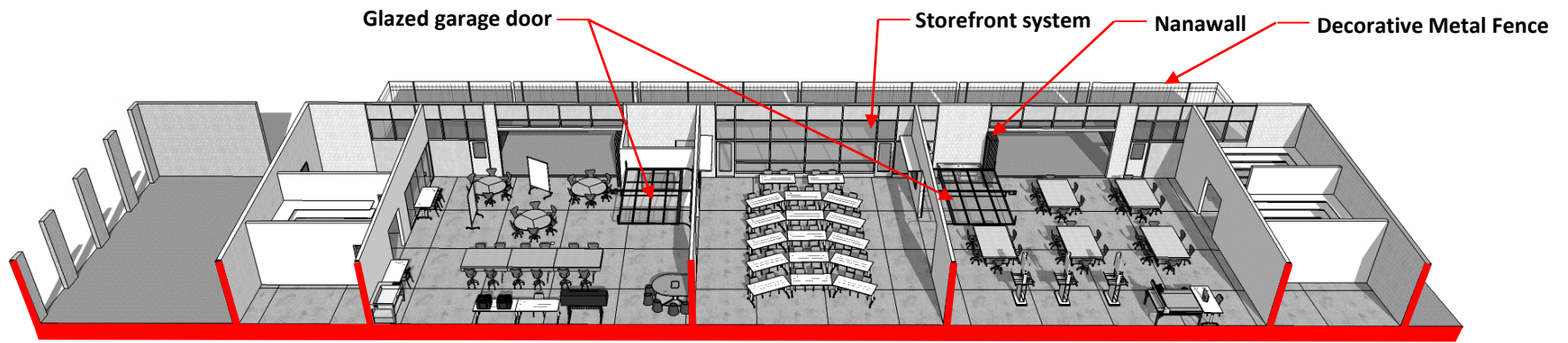

- Existing Lockers
- Storage
- Digital Playground
- Group Presentation & Lecture
- Fab Lab
- Storage

# BCA Model School MULTIPURPOSE

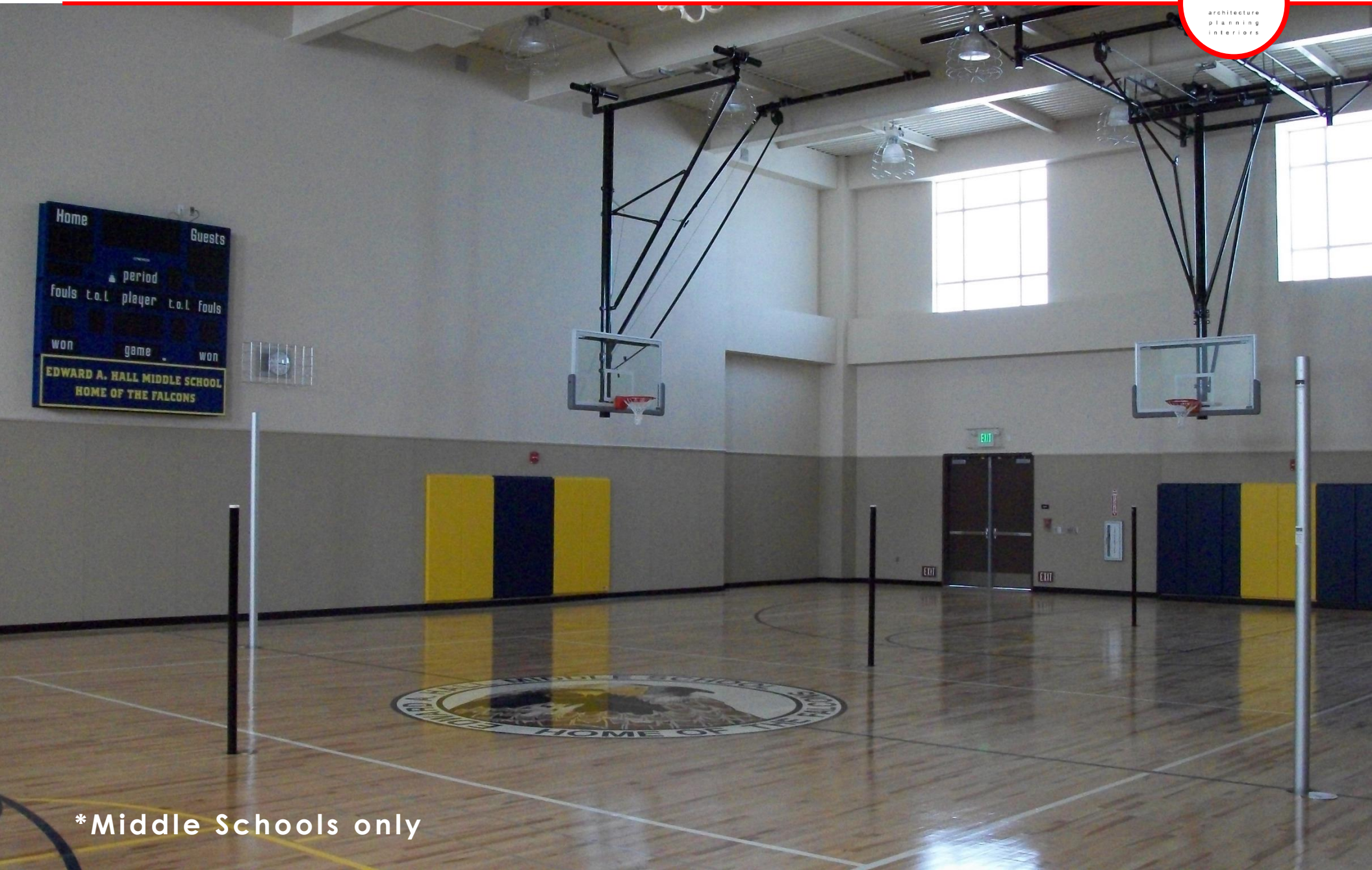

Home      Guests  
period  
fouls t.o.l. player t.o.l. fouls  
won      game      won  
**EDWARD A. HALL MIDDLE SCHOOL**  
**HOME OF THE FALCONS**

**\*Middle Schools only**

# Q & A

